

EXHIBITION AND SPONSORSHIP

Organizers

This conference is organized by National Central University, Taiwan, R.O.C. and Optics Design Group of the Optical Society of Japan, Japan.

Conference & Exhibition

June 01 (Tue) – 03 (Thu), 2021.

Deadline for returning the exhibition form: **May 01, 2021**

About ODF'20

The 12th International Conference on Optics-photonics Design & Fabrication (ODF'20) will be held during June 1st – 3rd, 2020, at the Department of Optics and Photonics, National Central University, Taoyuan, Taiwan. ODF'20 is intended to provide an international forum for original paper presentations and discussions on topics of optics-photonics designs and fabrications, including theory, design, fabrication, testing, applications, and others. Moreover, ODF'20 aims at seeking international collaborations among participants and company/corporations in a broad range of Optics and Photonics.

Exhibitions

1. Exhibition Site

Kwoh-Ting Optics and Photonics Building, National Central University, Taiwan.

2. Booth Proposal

- ✓ Booth space: 3m (wide) × 2m (depth) × 2.5 m (high)
- ✓ One table (180 cm × 60 cm) and two chairs
- ✓ Electric power: 110V, 2 sockets
- ✓ Three registration badges, including the banquet per booth
- ✓ Advertising page: One page, black and white advertisement in the ODF'20 Proceedings (another NTD \$10,000/page is required for color printing)

- ✓ Fee:

Booth Exhibition	Fee (Tax included)
Regular	NTD \$100,000
Early bird (Before 3/01)	NTD \$75,000

- a. 20% off the second booth
- b. Booth booking will be cancelled if the payment is not made by the due date.

- ✓ Exhibitors will be notified about the date for the selection of booth locations.
- ✓ The organizer reserves the right to refuse any unsuitable booth booking.

Product/Technical Seminars

- ✓ Seminar room capacity: 50 people, full loaded
- ✓ Seminars will be held during lunch time or conference break.
- ✓ One A4-page advertising leaflet in color printing is included.

30-min. Seminar	Fee (Tax included)
Regular	NTD \$35,000
Early bird (Before 3/01)	NTD \$25,000

- a. 20% off the second seminar
- b. Booking of seminar will be cancelled if the payment is not made by the due date.

Sponsorship

1. Advertisement on ODF'20 Proceedings and Conference Bags

Type	Option	Fee (Tax included)
Logo on	Half of one side	NTD \$60,000 (One AD only)
	Full side	NTD \$90,000 (One AD only)
Conf. bags	Reverse side of the front cover, <i>color</i> printing	NTD \$50,000 (One AD only)
	Back cover, <i>color</i> printing	NTD \$50,000 (One AD only)
	Reverse side of the back cover, <i>color</i> printing	NTD \$40,000 (One AD only)
	First inner page, <i>color</i> printing	NTD \$30,000 (One AD only)
	One full inner page, <i>color</i> printing	NTD \$15,000
	One full inner page, B/W printing	NTD \$10,000
	One half inner page, <i>color</i> printing	NTD \$8,000
One half inner page, B/W printing	NTD \$5,000	

2. Other Advertising Options

Option	Fee (Tax included)
Advertising pens/Logo pens	NTD \$40,000
Promotional notebook (20 page)	NTD \$40,000
L-shaped folder w/ LOGO	NTD \$40,000

3. Participation

USD 300 per person

Register Your Interest to Sponsor or Exhibit at ODF'20

Please return the Exhibition and Sponsorship form before May 01, 2021 to LED.tps@gmail.com A notification letter will be sent out once the request has been processed.

Payment

You are requested to pay the exhibition/sponsorship fee in full within one week after receiving the notification email.

✓ *Pay in NTD*

匯款戶名：中華民國光電學會

銀行：第一銀行平鎮分行

帳號：283-100-21073。

✓ *Pay in USD*

Remittance Account Name: TAIWAN PHOTONICS SOCIETY

Account Number: 28310021073

Bank SWIFT/BIC number (for wire transfer): FCBKWTWP

Bank Name: FIRST COMMERCIAL BANK

Branch: PINGZHEN

Address: NO. 30, SEC 1, CHUNGKING SOUTH ROAD, TAIPEI CITY

Country: TAIWAN

✓ *Pay by check*

Make Check Payable to: 中華民國光電學會

Mailing address: Taiwan Photonics Society

Kwoh-Ting Optics and Photonics Building, No.300, Zhongda Rd., Zhongli

Dist., Taoyuan City 32001, Taiwan

✓ Exhibition/sponsorship fee must be paid before May 08, 2021.

✓ Please email the Exhibition/Sponsorship Payment Confirmation Form (p. 6) and your organization's logo to LED.tps@gmail.com. The billing contact will receive a payment confirmation email after the payment is confirmed.

Exhibition (B1)

booth
3x2m²

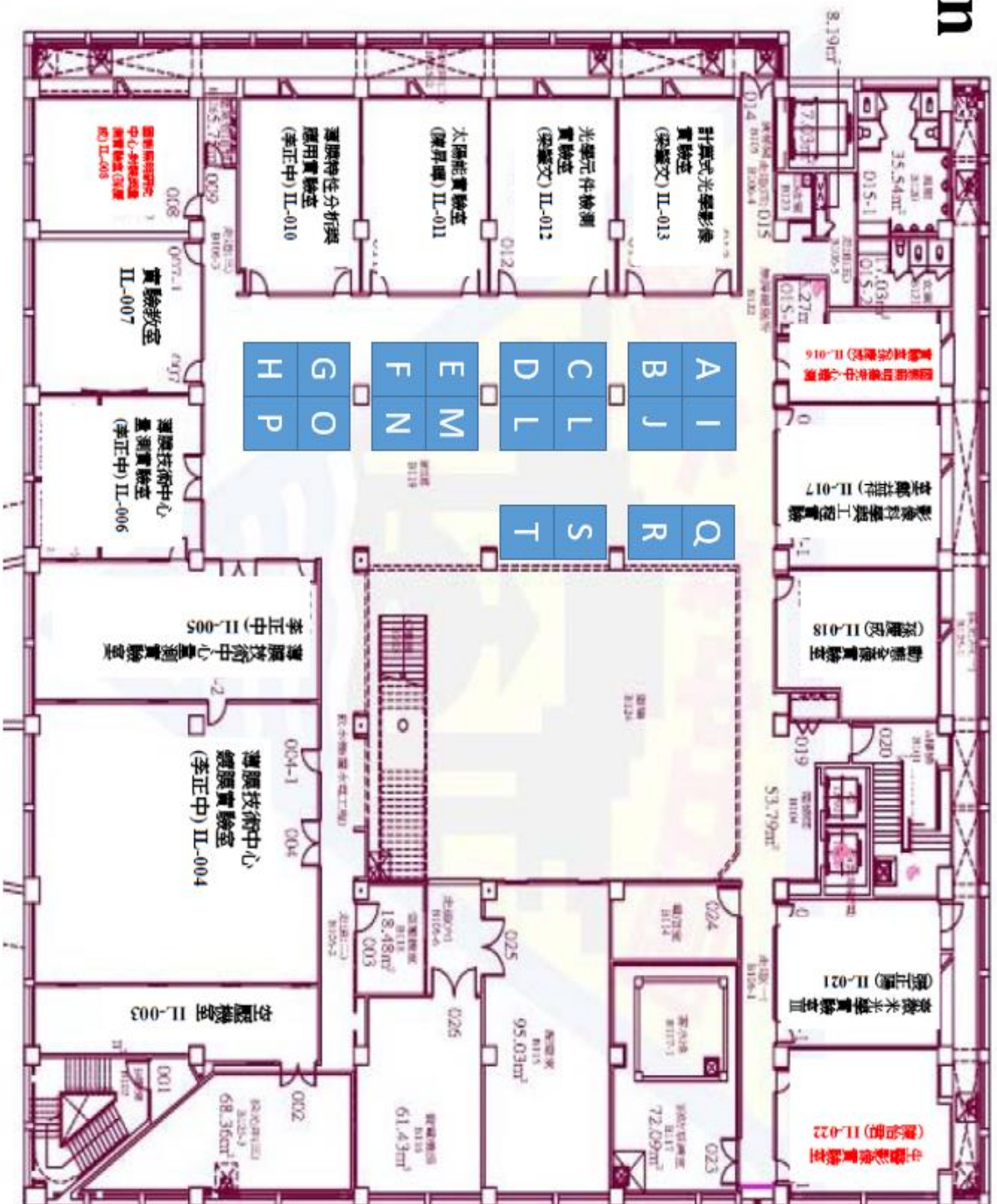

ODF'20 Exhibition and Sponsorship Form					
No.	(by ODF'20)	Company name (English)			
GUI number		Company name (Chinese)			
Tel		URL:			
Fax		Company address			
Mailing address	<input type="checkbox"/> Same as the company address <input type="checkbox"/>				
Event manager	Name	Dept./Title	Tel/Ext	Mobile	E-mail
Person of contact	Name	Dept./Title	Tel/Ext	Mobile	E-mail
Exhibition/Sponsorship					
<input type="checkbox"/> Booth Booking: No. of Booths: _____ <input type="checkbox"/> Early bird <input type="checkbox"/> Regular					
<input type="checkbox"/> Product/Technical Seminar: No. of Units: _____ (30 min./unit) <input type="checkbox"/> Early bird <input type="checkbox"/> Regular					
<input type="checkbox"/> Advertisement on Conf. Bags <input type="checkbox"/> Bag logo (half of one side) <input type="checkbox"/> Bag logo (one full side)					
<input type="checkbox"/> Advertisement on ODF'20 Proceedings <input type="checkbox"/> Front cover (reverse side, color) <input type="checkbox"/> Back cover (color) <input type="checkbox"/> Back cover (reverse side, color) <input type="checkbox"/> First inner page (color) <input type="checkbox"/> One full inner page (color) <input type="checkbox"/> One full inner page (B/W) <input type="checkbox"/> One half inner page (color) <input type="checkbox"/> One half inner page (B/W)					
<input type="checkbox"/> Other Advertising Options <input type="checkbox"/> Advertising pen w/ logo <input type="checkbox"/> Promotional notebook w/ logo <input type="checkbox"/> L-shaped folder w/ logo					
<input type="checkbox"/> Participation <input type="checkbox"/> USD300 per person: _____ person(s)					
Total exhibition/Sponsorship fee: (written by ODF'20)				Reviewer	

The exhibitor/sponsor is committed to follow the rules and conditions set by ODF'20 organizers and the National Central University. The exhibitor shall take full legal responsibility if any violation occurred.

Person of application (Signature): _____ Date: _____

ODF'20 Exhibition/Sponsorship Payment Confirmation Form			
Company Name		Title of Return Receipt	
GUI number		Mailing Address	
Contact Person of the Payment		Contact Person's TEL	
Name of the Remitter		Contact Person's Email Address	
Amount of Remittance		Time of Remittance	
Paste the copy/image of the remittance slip or check here <hr style="border-top: 1px dotted black;"/>			

Contact Us

If you have any question please feel free to contact us at

	Person	TEL	E-mail
NCU	Prof. Sheng-Hui CHEN	+886-3-422-7151 ext:65294	ericchen@dop.ncu.edu.tw
	Prof. Chien-Cheng KUO	+886-3-422-7151 ext:65279	cckuo@dop.ncu.edu.tw
TPS	Mr. Yao-Tian HUANG	+886-3-427-1466 +886-978-541158	LED.tps@gmail.com